

Specifications

dimmable	5-grade brightness
Max luminous(30cm)	>1500LUX (30CM)
luminous flux	> 500LM
Working voltage	12V
Color temperature	Cold light 5500K ± 550K Warm light 2800K ± 280K Natural light 4000K ± 400K
Maximum wattage	12W

Warranty Card

Applicable for:

- Since buying date, the user enjoys one year free repair services under normal use. After one year, will be charged according to each component part cost.
- In case change component part, will be charged according to our company's component part cost list.
- The following situations not free repair in Warranty period.
 - 1) Damage caused by natural earthquake, rat disaster, and unnormal use.
 - 2) Damage caused in transportation, fall, and unproper storage.
 - 3) Consumable component, such as spare parts, batteries, light bulbs, etc.
 - 4) Warranty information record is not complete, no purchase date, no buying shop seal, etc.
 - 5) Featured using environment, such as humidity, sulfur area, high salty and the ship, etc, easy corrosion area.
 - 6) Using not according to the instructions.
 - 7) Special offer.
- When return to factory for repair, the user should make sure the LED lamp packed properly, to avoid any damage during transportation.
- Factory not responsible for the damages caused by the user themselves unproper disassemble.

Important!

Thank you for purchasing our products. To guarantee your rights, please fill in this form properly, thank you!

Name
Address
Telephone
Invoice number
Purchase date
Item number

dealers **Note: this field requires the dealers seal!**

Warning please keep this warranty paper for repair presentation.

Attention:

- Do not Self-disassemble the product, to avoid any electric shock.
- Please use vender's specified adapter and power socket, to maintain normal working.
- Please do not over-adjusting the joint activity parts, to avoid any damage to the lamp.
- Please do not use the lamp in high-temperature or high-humidity environment.
- Please don't look at the LED lightsouce straightly, to avoid your eyes hurt.
- In case below conditions occur, please pull out the power cord, stop using (if needed, please call for help):
 - The power cord or power plug break
 - The lamp holder damp or rain
 - The shell and joint activities of the lamp holder breaks
 - The lamp holder smokes or sparks
 - The abnormal flickering or break of the LED light bulb

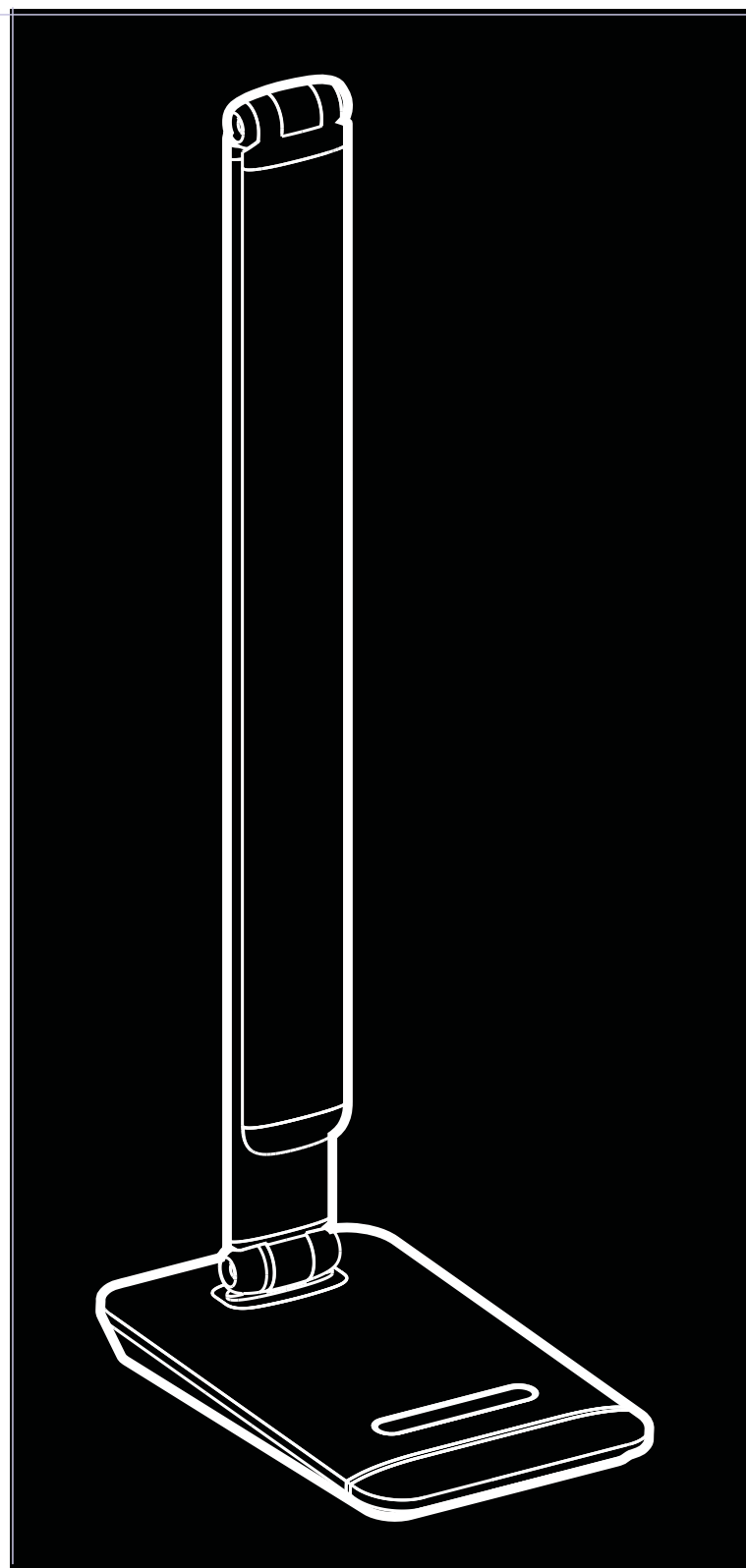

技术参数

调光	5级调光	工作电流	12V
产品照度	> 1500LUX	台灯色温	冷光 5500K+ .550k 暖光 2800K+ .280k 自然光 4000K+ .400k
最大功率	12W		

产品售后服务保证卡

适用范围:

- 本产品自购买日起, 正常使用情况下保证一年免费服务, 若超过保质期将收取一定零件成本费用。
- 如需更换零件的服务, 依照本公司服务零件检修价目表收费。
- 在下列情况时, 虽然在有效保证期间内, 恕不免费保证。
 - 1.因天灾地震、鼠祸公害、未正确使用所导致故障或损坏的。
 - 2.购买后的运送、移动落下、保存不当等所造成的故障或损坏。
 - 3.损耗品如零附件、电池、灯泡等。
 - 4.保证书信息记录不完全, 未填入购买日期、无购买店盖章的。
 - 5.特色环境不保修, 如潮湿、硫磺区、海边高盐分及船上等易腐蚀地区。
 - 6.未按照使用说明书使用者。
 - 7.特殊约定销售的产品。
- 产品返厂维修时, 送修时应自行妥善包装维修品, 以免在运送途中造成损害。
- 自行拆装产品导致的产品故障, 制造方概不负责。

重要!

感谢您购买本产品, 为保证您权益, 请妥善填写, 谢谢!!

姓名
地址
电话
发票号码
购买日期
产品型号
经销商 Note: 本栏请加盖经销商印章。

注意 *请妥善保管您的产品保证书, 保修期需出示核对

注意事项

- 请勿自行拆解产品, 以免触电。
- 请依照制造商指定专用变压器及电源插座使用, 以维持产品正常运作。
- 请勿过度调节产品的活动关节部分, 以免灯具关节功能损伤。
- 使用时请勿将产品置于不稳固的桌面, 以免产品掉落损坏。
- 请勿将产品置于高温或高湿度的地方。
- 为避免造成眼睛伤害, 请不要直视LED灯泡光源。
- 遇下列状况时, 请先拔掉电源线, 停止使用。
 - *电源线或电源插头损坏或破损时。
 - *本灯座受潮或淋到雨。
 - *本灯座外壳, 活动关节处有损坏时。
 - *本灯座发生冒烟, 火花等安全因素。
 - *LED灯泡异常闪烁或损坏时。
- 如有问题请咨询客服人员:

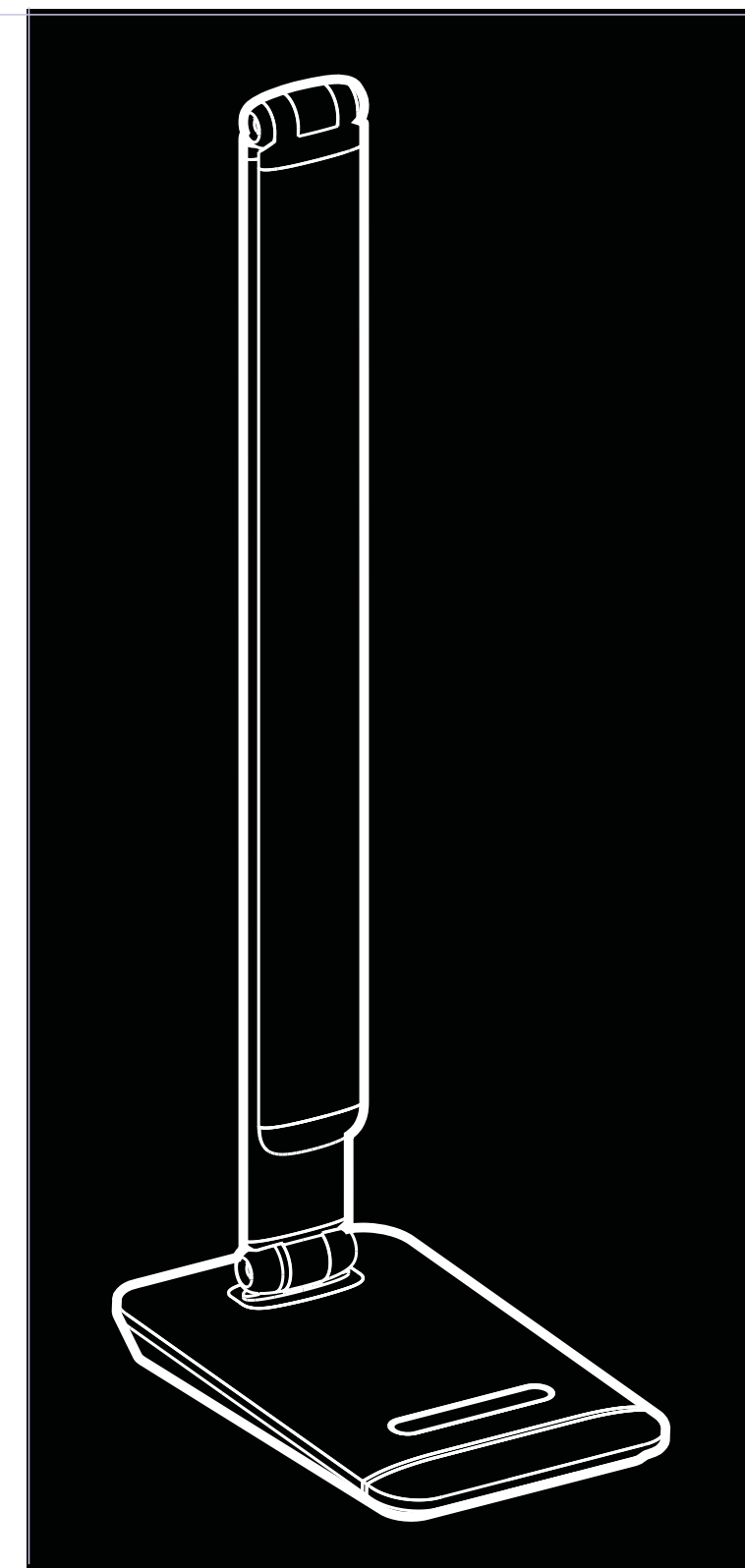

Battery replacement

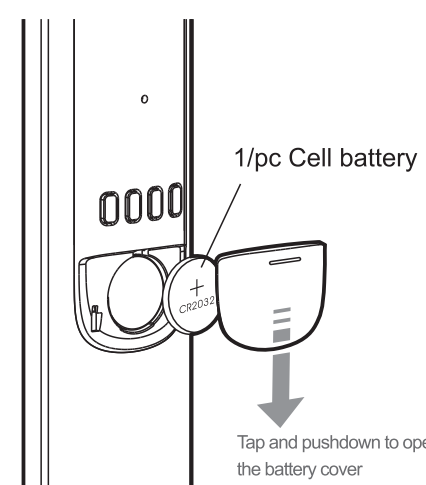

1/pc Cell battery

Tap and pushdown to open the battery cover

LCD screen brightness

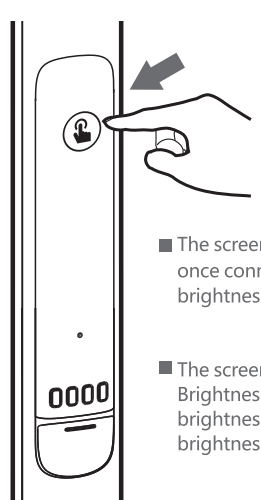

The screen will light automatically once connect Electric, default brightness is the highest.

The screen brightness controller key, Brightness will change from weak brightness-middle brightness-high brightness-off (cycle)

User guider

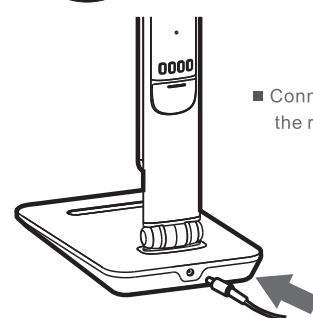

Connect the power adapter in the rear of the Lamp arm.

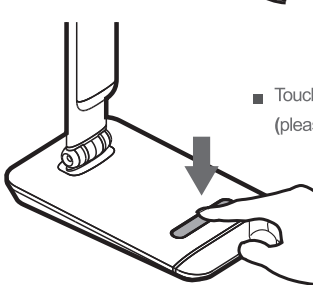

Touch buttons, touch dimmer (please refer to the instructions for use keys)

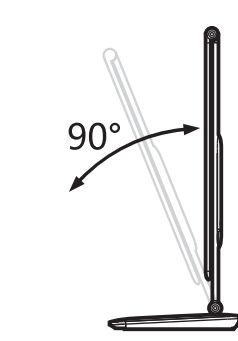

Lighting area:
Adjustable angle of the Lamp stand: 90°

When adjusting the lamp arm, please hold the base

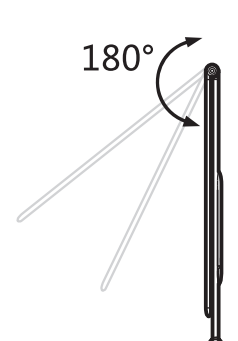

The lamps arm and chimney activities:

When adjusting the lamp arm, please hold the base
Arm adjustable range: 180° (excessive adjustment may cause damage)

When adjusting thechimney, please mind the joint-part to avoid clipping hands

Operation instructions

Touch key: Light adjustable instruction (as picture below)

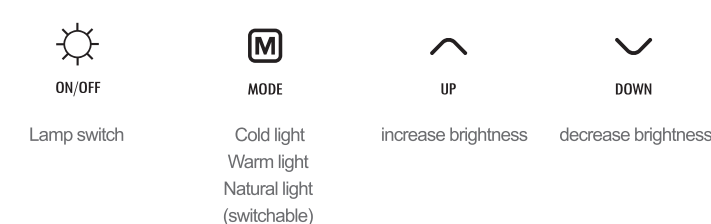

Nightlight button operation (as picture below)

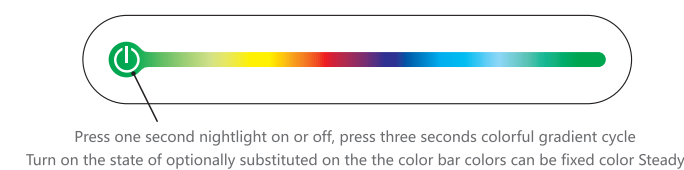

Press one second nightlight on or off, press three seconds colorful gradient cycle Turn on the state of optionally substituted on the the color bar colors can be fixed color Steady

Calendar operation instruction:(as below picture)



Date and Time setting

- 1.In normal mode,press "set" key to achieve setting functions, press against to move next, sequence:
Hour-Minute-Year-Month-Day.
2. Press "up" and "down" to setting, week changes automatically when date change.
3. In setting mode,press mode or stop operation in one munite to exit setting, and display time.
4. In normal mode,press "down" key to switch between"12H"or"24H" display.

Snooze function setting

1. In normal mode, press "mode" key to active alarm setting.
2. In alarm mode,press "set" key to set the alarm time, sequence:
Hour-Munite-Snooze-Music-Exit.
3. Press "up"and"down"to setting
4. In alarm mode,press "up" and "down" to turn on/off alarm and snooze function, press again to achieve next function, sequence: alarm on- snooze on-alarm off-snooze off
5. When come to alarm time, will ring 1 munite, then snooze and ring again. Press any key to off alarm.

Temperature switch

- In normal mode,press "down" key to switch between "F" and "C" display.

电池更换

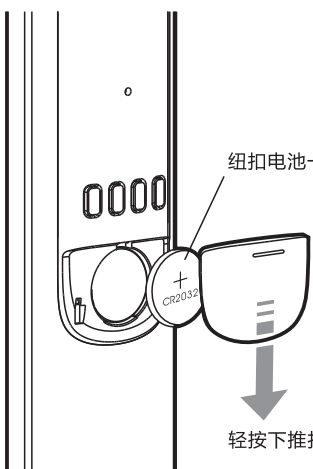

纽扣电池一枚

轻按下推打开电池盖

屏幕亮度



上电LCD自动点亮, 默认为最亮

触摸屏幕亮度控制键, 亮度变化为: 微亮—中亮—高亮—关闭(循环)

使用说明

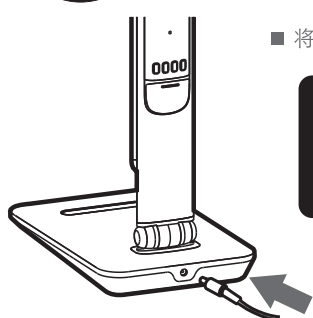

将电源变压器插入灯臂后方的电源插孔内。

注意 内附的电源变压器为本产品专用, 不能用于其他电器。

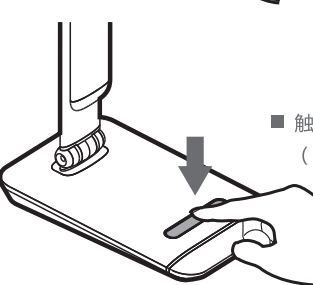

触摸按键, 轻触调光 (详情请参阅按键使用说明)

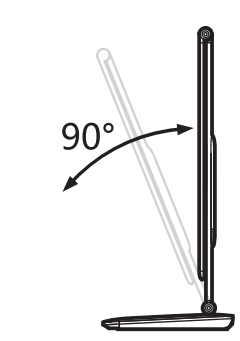

灯具前摆使用范围为90°
在调整灯臂角度时, 请同时按压底座。

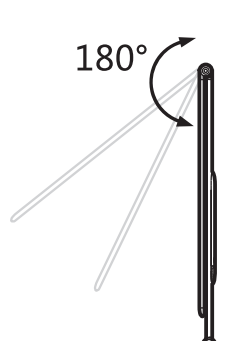

灯头可调整范围为180° (过度调节产品的活动关节会导致关节功能损坏)

操作说明



台灯开关 冷光-暖光-自然光切换 调亮 调暗

小夜灯按键操作:(如图)



短按一秒开或关小夜灯, 长按三秒七彩循环渐变 开启状态在色条上任选颜色可固定色彩常亮

万年历闹钟操作说明:(如图)



日期和时间的设置

- 1.正常模式下, 按设置键启动日期和时间的设置功能, 再按一下进入下个选项的设置设置的顺序为: 时—分—年—月—日—退出
- 2.按上调和下调键进行设置, 星期会随着日期的变化而自动变化。
- 3.在设置状态下, 按模式键或1分钟无操作进, 将退出设置, 并即时显示时间。
- 4.在正常状态下, 按上调键转换12小时制或24小时制。

贪睡功能设置

- 1.正常状态下, 按模式键进入闹铃模式
- 2.在闹铃模式下, 按设置键进入闹铃设置, 再按一下进入下个选项的设置其顺序为: 时—分—贪睡—音乐—退出
- 3.按上调和下调键进行设置。
- 4.在闹铃模式下, 按上调和下调键可开启和关闭闹铃和贪睡功能, 再按一下启动下一个功能标记, 顺序为: 开响闹—开贪睡—关响闹和贪睡
- 5.当到达闹铃时间时, 闹铃将持续1分钟, 贪睡时间到时, 闹铃会再次响起。按设置键或按任意键停止铃声。

温度转换

在正常状态下, 按下调键以转换摄氏和华氏温度。